

Directional valves ▶ Pneumatically operated

Series 840

Brochure



Directional valves ▶ Pneumatically operated

Series 840



4/2-directional valve, Series 840

▶ Single air pilot ▶ Qn = 200 l/min ▶ pipe connection ▶ Compressed air connection
output: Ø6x1

3

Accessories



Subbases and accessories, Series 840

5



Silencers, Series SI1

▶ Sintered bronze

6



Name plates

7

Directional valves ▶ Pneumatically operated

4/2-directional valve, Series 840

▶ Single air pilot ▶ Qn = 200 l/min ▶ pipe connection ▶ Compressed air connection output: Ø6x1



00138519_a

Version	Poppet valve
Sealing principle	Soft sealing
Mounting on manifold strip	PRS strip
Working pressure min./max.	2 bar / 10 bar *
Control pressure min./max.	2 bar / 10 bar
Ambient temperature min./max.	-15 °C / +60 °C *
Medium temperature min./max.	-15 °C / +60 °C *
Medium	Compressed air
Max. particle size	50 µm
Oil content of compressed air	0 mg/m³ - 1 mg/m³

Materials:

Housing	Polyoxymethylene
Seals	Acrylonitrile butadiene rubber
Threaded bushing	Polyoxymethylene

* The maximum operating pressure depends on the ambient temperature. The following values are applicable:

- 15 °C - 60 °C: Operating pressure 1.5 bar - 8 bar possible.
- 15 °C - 40 °C: Operating pressure 1.5 bar - 10 bar possible.

Technical Remarks

- The min. control pressure must be adhered to, since otherwise faulty switching and valve failure may result!
- The pressure dew point must be at least 15 °C under ambient and medium temperature and may not exceed 3 °C.
- The oil content of compressed air must remain constant during the life cycle.
- Use only the approved oils from AVENTICS, see chapter „Technical information“.

	Compressed air connection				Flow rate value	Weight	Note	Part No.
	Input	Output	Exhaust	Pilot control exhaust				
					[l/min]	[kg]		
	Ø6x1	Ø6x1	Ø6x1	Ø6x1	200	0.048	1)	5718400000

1) See diagram
Nominal flow Qn at 6 bar and Δp = 1 bar

4/2-directional valve, Series 840

▶ Single air pilot ▶ $Q_n = 200$ l/min ▶ pipe connection ▶ Compressed air connection output: $\text{Ø}6 \times 1$

Control pressure

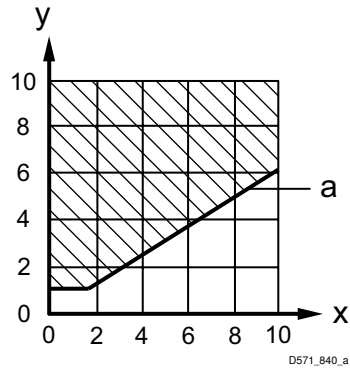

Pilot pressure range diagram

x: working pressure (bar)

y: pilot pressure (bar)

a: min. pilot pressure at port 14 (Z) depending on working pressure

Dimensions

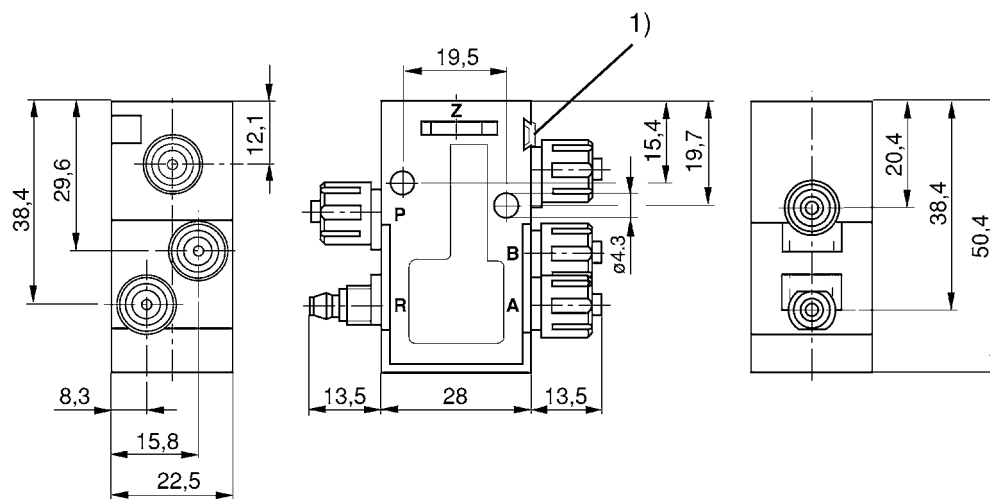

1) mounting space for name plate

D571_840

Directional valves ▶ Pneumatically operated

Series 840
Accessories

Subbases and accessories, Series 840

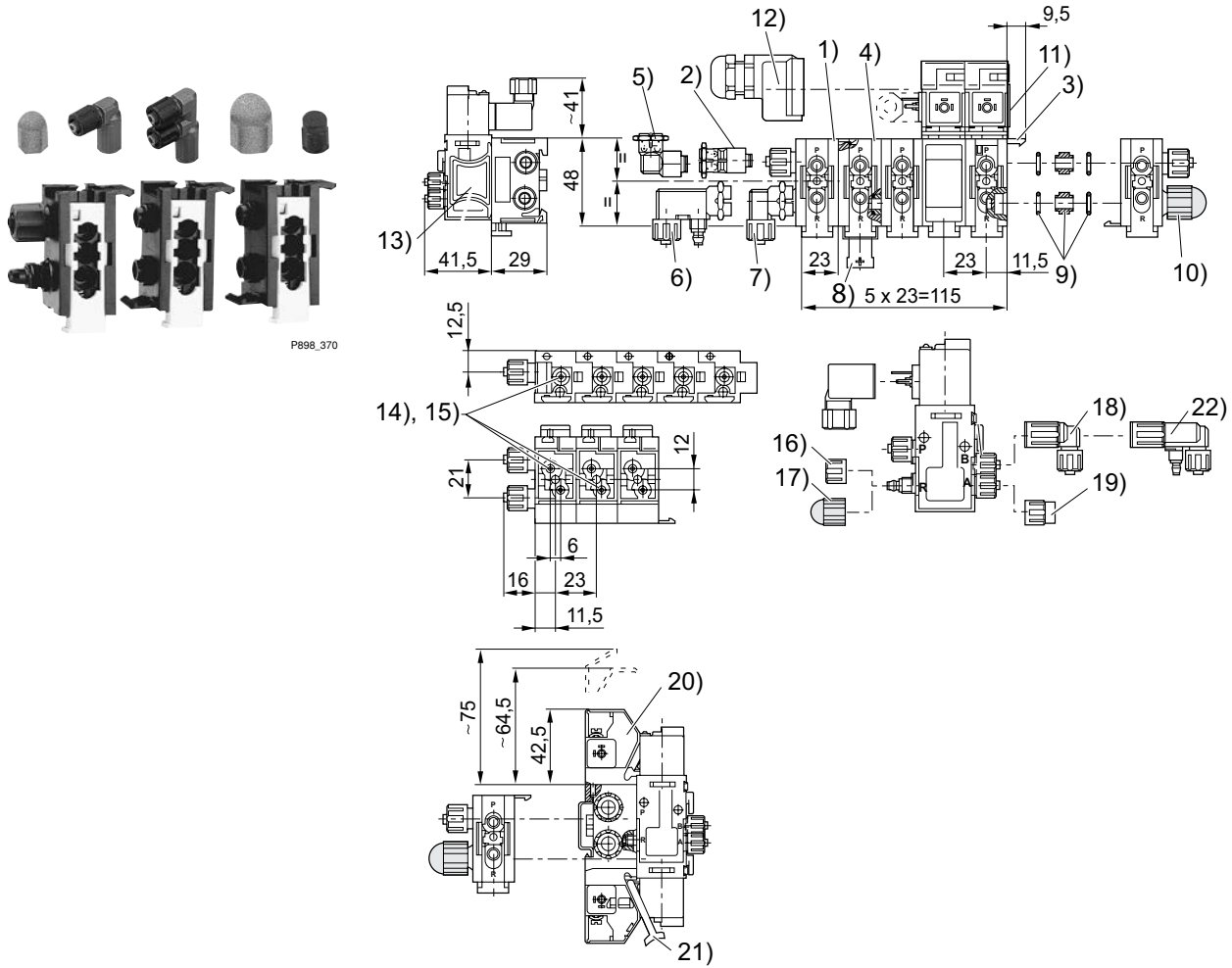

00133202

Part No.	Type	Material	Material Seal	Fig.		
8985003702	Supply plate complete with seals	Polyoxymethylene	Acrylonitrile butadiene rubber	Fig. 1		
8938000910	Reducing fitting Ø 8x1 to Ø 6x1, push-in incl. O-ring	-	-	Fig. 2		
8938000920	Reducing fitting Ø 8x1 to Ø 8x1, push-in incl. O-ring	-	-	Fig. 2		
8985003722	End plate, complete with O-rings	Polyoxymethylene	Acrylonitrile butadiene rubber	Fig. 3		
8985003712	sandwich plate complete with seals	Polyoxymethylene	Acrylonitrile butadiene rubber	Fig. 4		
8938306550	elbow fitting Ø 8x1 to Ø 6x1, push-in, incl. O-ring	-	-	Fig. 5		
8938306560	elbow fitting Ø 8x1 to Ø 8x1, push-in, incl. O-ring	-	-	Fig. 5		
8938307900	Elbow fitting, 2x, plastic tubing Ø 6x1 for supply plate	-	-	Fig. 6		
8938307800	Elbow fitting, 2x, plastic tubing Ø 8x1 for supply plate	-	-	Fig. 6		

Series 840 Accessories

Part No.	Type	Material	Material Seal	Fig.		
8938306500	Elbow fitting, 1x, plastic tubing Ø 6x1 for supply plate	Polyoxymethylene	Acrylonitrile butadiene rubber	Fig. 7		
8938306510	Elbow fitting, 1x, plastic tubing Ø 8x1 for supply plate	Polyoxymethylene	Acrylonitrile butadiene rubber	Fig. 7		
5728400414	Cover plate for manifold	Polyamide	-	Fig. 8		
5728400092	Connecting kit for second inlet base	Brass	Acrylonitrile butadiene rubber	Fig. 9		
5324002020	silencer for port R of supply plate	Sintered bronze	-	Fig. 10		
5728400424	Cover plate for plug module	Polyamide	-	Fig. 11		
8942003902	PG-fitting for plug module	Polyamide	-	Fig. 12		
5728406004	Dummy flange for reserve places complete with seals	Polyamide	-	Fig. 13		
8938009390	Tubing connector for separate or additional P-supply for plastic tubing Ø 6x1	Brass	-	Fig. 14		
8938013600	Tubing connector for separate or additional P-supply for plastic tubing Ø 5x1	Brass	-	Fig. 15		
8930714804	Tube nut for valve conn. R	Polyamide	-	Fig. 16		
5324002000	silencer for valve connection R	Sintered bronze	-	Fig. 17		
8938403900	Elbow fitting 1x, for tubing Ø6x1, incl. O-ring	Polyoxymethylene	-	Fig. 18		
8930715002	Screw plug for valve connection A or B	Polyamide	-	Fig. 19		
8941013312	El. conn. module for max. 250 V, with cable conduit	Polyamide	-	Fig. 20		
5728417904	Actuating element+	Polyethylene	-	Fig. 21		
8938403950	Elbow fitting, 2x, for tube Ø6x1, incl. O-ring and tube nut	Polyoxymethylene	-	Fig. 22		

Silencers, Series SI1 ▶ Sintered bronze



P899_380

Working pressure min./max. 0 bar / 10 bar
 Ambient temperature min./max. -25°C / +80°C
 Medium Compressed air

Materials:
 Silencers Sintered bronze

Weight	Part No.
[kg]	
0.008	8993800114

Dimensions

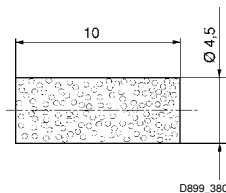

Directional valves ▶ Pneumatically operated

Series 840
Accessories

Name plates



P894_305

Part No.	Type	Order quantity [Piece]								
8943056312	1-10	5								
8943056322	11-20	5								

AVENTICS GmbH
Ulmer Straße 4
30880 Laatzen, GERMANY
Phone +49 511 2136-0
Fax +49 511 2136-269
www.aventics.com
info@aventics.com



Find more contact information at
www.aventics.com/contact

Only use the AVENTICS products shown in industrial applications. Read the product documentation completely and carefully before using the product.

Observe the applicable regulations and laws of the respective country. When integrating the product into applications, note the system manufacturer's specifications for safe use of the product.

The data specified only serve to describe the product.

No statements concerning a certain condition or suitability for a certain application can be derived from our information.

The information given does not release the user from the obligation of own judgment and verification. It must be remembered that the products are subject to a natural process of wear and aging.

16-03-2017

An example configuration is depicted on the title page. The delivered product may thus vary from that in the illustration. Subject to change. © AVENTICS S.à r.l.
This document, as well as the data, specifications and other information set forth in it, are the exclusive property of AVENTICS S.à r.l.. It may not be reproduced or given to third parties without its consent. PDF online